



CHATTERTON | REES



## Flat 17 Britten House, London, SW3 3UB Asking price £500,000

This attractive studio apartment is found on the second floor (lift) of this highly sought after block, situated in a desirable location next to St Luke's Gardens. The unit has been newly refurbished throughout and comprises a studio room, with separate kitchen and bathroom. Being so centrally located, this property would make a good rental investment, home or pied à terre.

Located just North of the King's Road in a quiet setting, Britten House is a secure, well-maintained property that is nestled enviably right in the heart of Chelsea close to all the shops, restaurants and transport facilities of the area. The nearest underground is Sloane Square (District & Circle Lines).



# Britten House

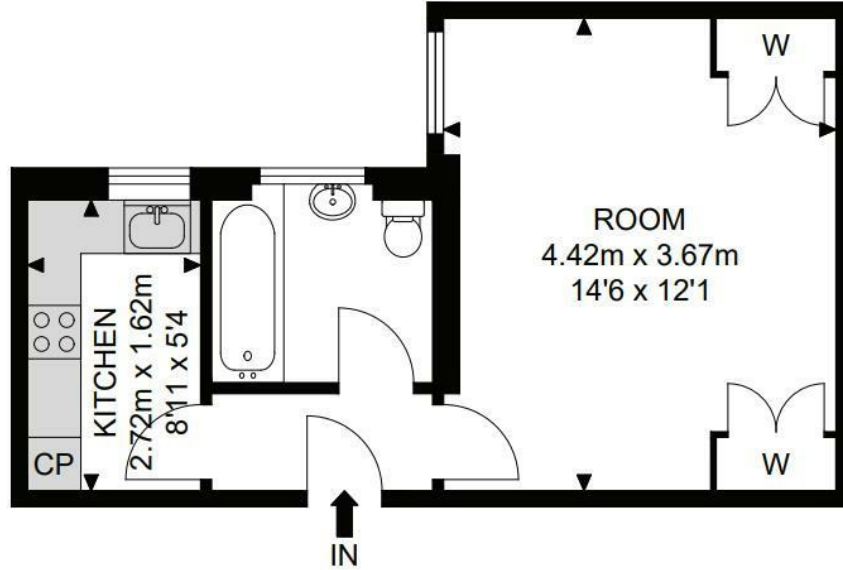

## 2nd Floor



### Area Map



### Energy Efficiency Graph

Energy Efficiency Rating		
	Current	Potential
Very energy efficient - lower running costs		
(92 plus) <b>A</b>		
(81-91) <b>B</b>		
(69-80) <b>C</b>		
(55-68) <b>D</b>		
(39-54) <b>E</b>		
(21-38) <b>F</b>		
(1-20) <b>G</b>		
Not energy efficient - higher running costs		
<b>England &amp; Wales</b> EU Directive 2002/91/EC		
Environmental Impact (CO <sub>2</sub> ) Rating		
	Current	Potential
Very environmentally friendly - lower CO <sub>2</sub> emissions		
(92 plus) <b>A</b>		
(81-91) <b>B</b>		
(69-80) <b>C</b>		
(55-68) <b>D</b>		
(39-54) <b>E</b>		
(21-38) <b>F</b>		
(1-20) <b>G</b>		
Not environmentally friendly - higher CO <sub>2</sub> emissions		
<b>England &amp; Wales</b> EU Directive 2002/91/EC		

These particulars, whilst believed to be accurate are set out as a general outline only for guidance and do not constitute any part of an offer or contract. Intending purchasers should not rely on them as statements of representation of fact, but must satisfy themselves by inspection or otherwise as to their accuracy. No person in this firm's employment has the authority to make or give any representation or warranty in respect of the property.